

UPS2



UPS2 /8 m



UPS2 /4-5-6 m



BG: Предупреждение

Този продукт може да се използва от деца на 8 и повече години и лица с физически, сетивни или умствени увреждания или липса на опит и познания за продукта, ако са под надзор или са ясно инструктирани за безопасно използване на продукта. Такива лица трябва също да са наясно с опасностите, произтичащи от използването на продукта. Никога не допускайте деца да си играят с продукта. Почистването и поддръжката от потребителя не трябва да

се извършват от деца или лица с понижени физически, сетивни или умствени способности без съответен надзор.

GR: Προειδοποίηση

Αυτό το προϊόν μπορεί να χρησιμοποιηθεί από παιδιά ηλικίας 8 ετών και πάνω, καθώς και από άτομα με μειωμένες σωματικές, αισθητηριακές ή πνευματικές ικανότητες ή χωρίς την ανάλογη εμπειρία και γνώση του προϊόντος, με την προϋπόθεση ότι βρίσκονται υπό την επίβλεψη άλλου ατόμου ή ότι έχουν λάβει σαφείς οδηγίες σχετικά με την ασφαλή χρήση

του προϊόντος. Τα άτομα αυτά θα πρέπει επίσης να κατανοούν τους κινδύνους που ενέχει η χρήση του προϊόντος. Ποτέ μην επιτρέψετε σε παιδιά να παίξουν με το προϊόν.

RO: Avertizare

Acest produs poate fi utilizat de copiii cu vârsta de cel puțin 8 ani precum și de persoanele cu capacități fizice, senzoriale sau mentale reduse sau care nu au experiență cu, și cunoștințe despre produs, cu condiția de a fi sub supraveghere sau de a li se da instrucțiuni clare pentru utilizarea produsului în condiții de siguranță. Aceste persoane trebuie de asemenea să înțeleagă pericolele

implicate de utilizarea produsului. Nu permiteți niciodată copiilor să se joace cu produsul. Curățarea și întreținerea de către utilizator nu trebuie efectuate de copii sau persoane cu capacități fizice, senzoriale sau mentale reduse fără o supraveghere corespunzătoare.

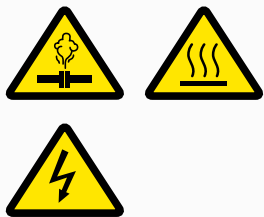

Max. 95 % RH
IP44

UPS2
4-5-6-8 m



Min./Max.
+2 °C / +95 °C



Max. 1.0 MPa
(10 bar)



Min./Max.
0 °C / +40 °C



< 43 dB(A)



UPS2
4-5-6-8 m



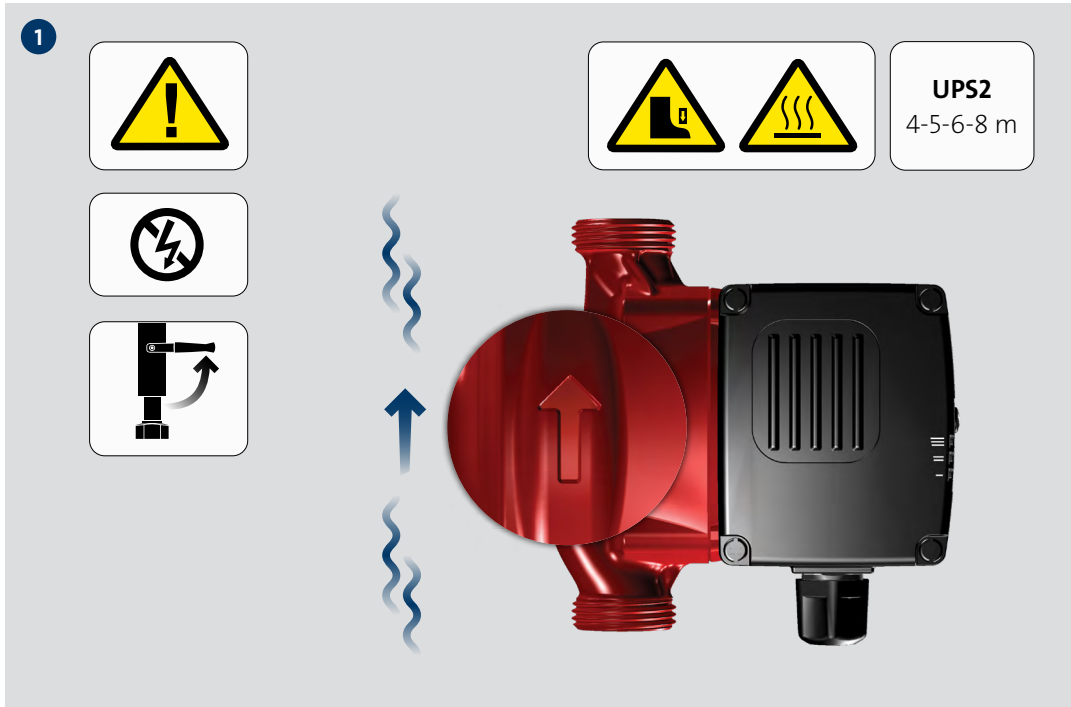
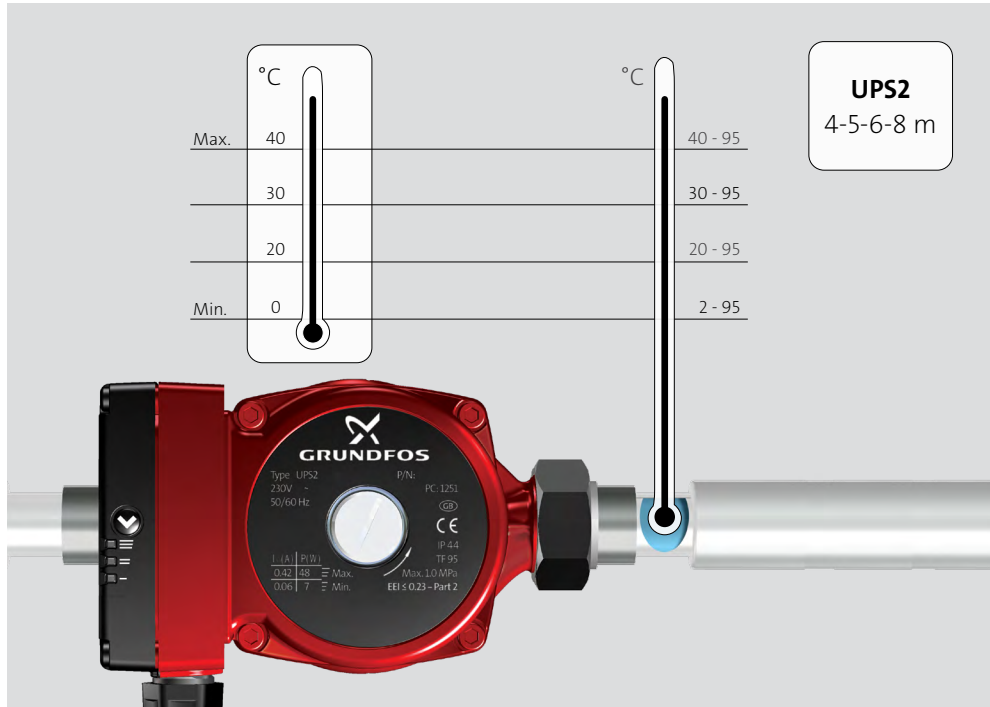



UPS2
4-5-6-8 m

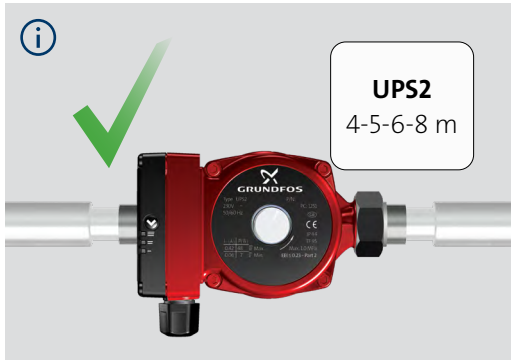
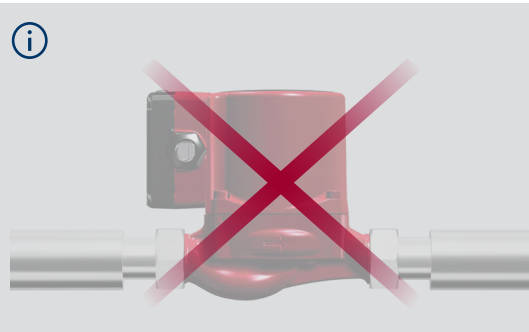

UPS2
4-5-6-8 m

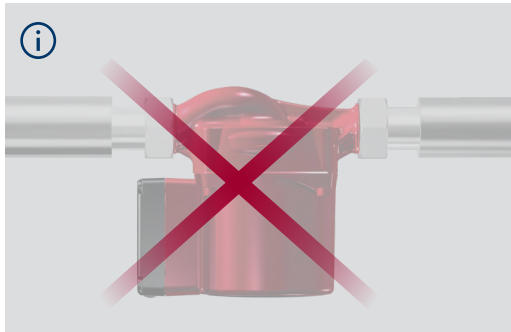



2

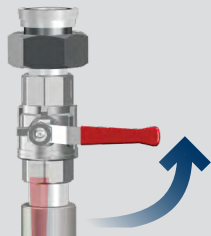
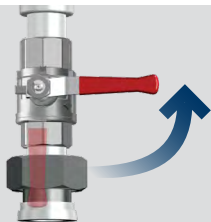

3

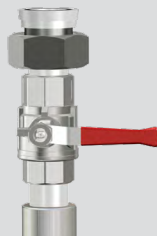

UPS2
4-5-6-8 m

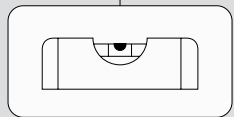
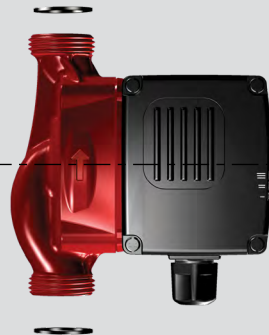

4





5

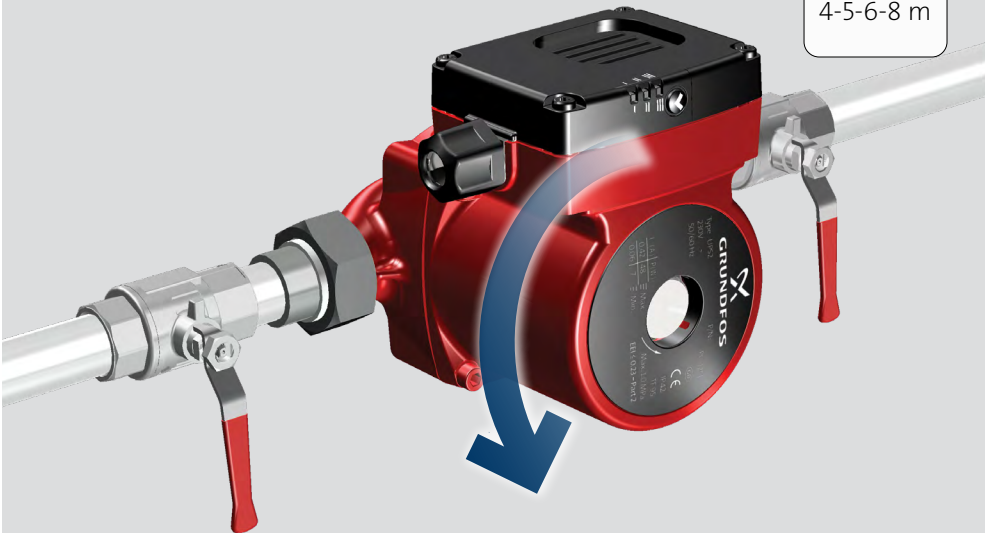

UPS2
4-5-6-8 m

6

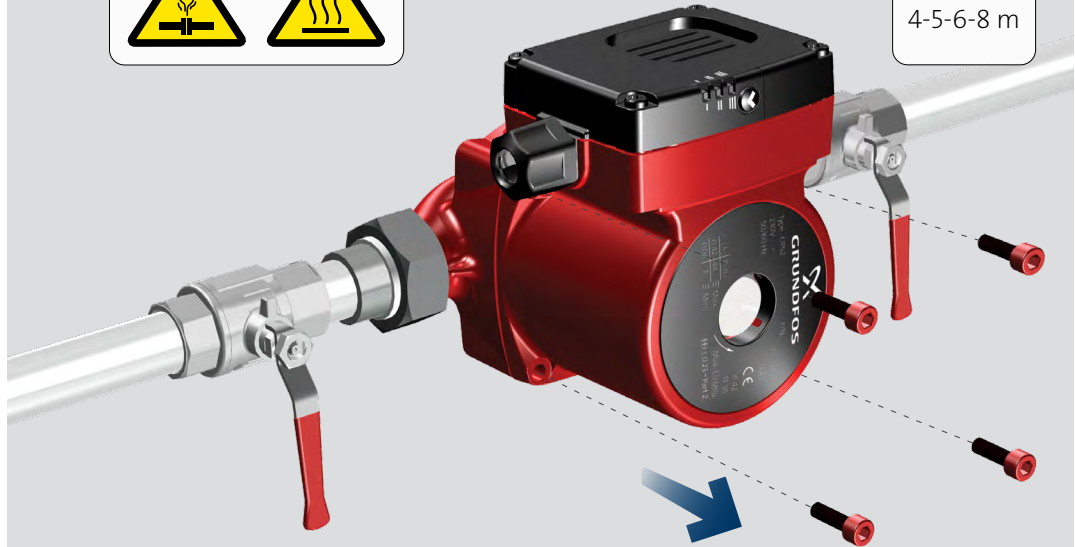

UPS2
4-5-6-8 m



7



UPS2
4-5-6-8 m

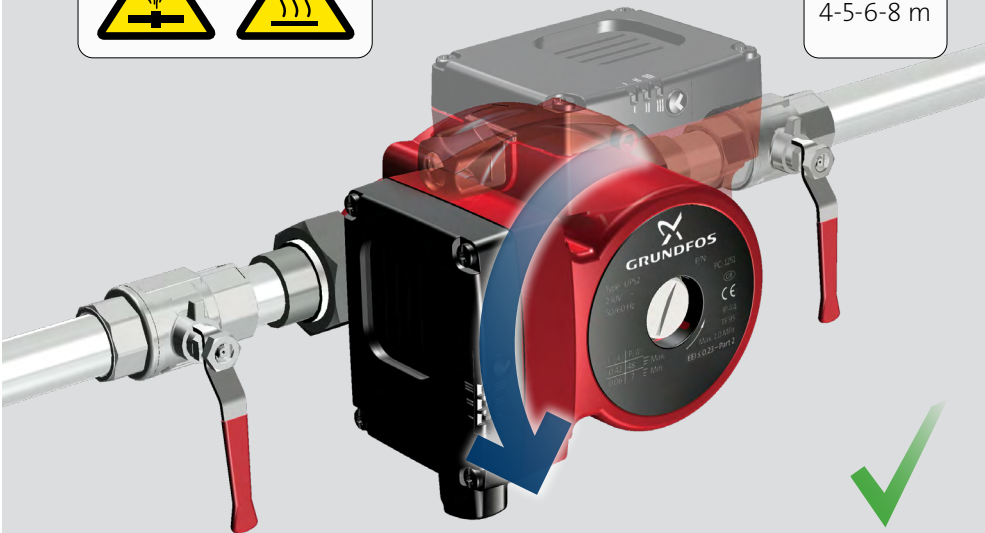

8



UPS2
4-5-6-8 m

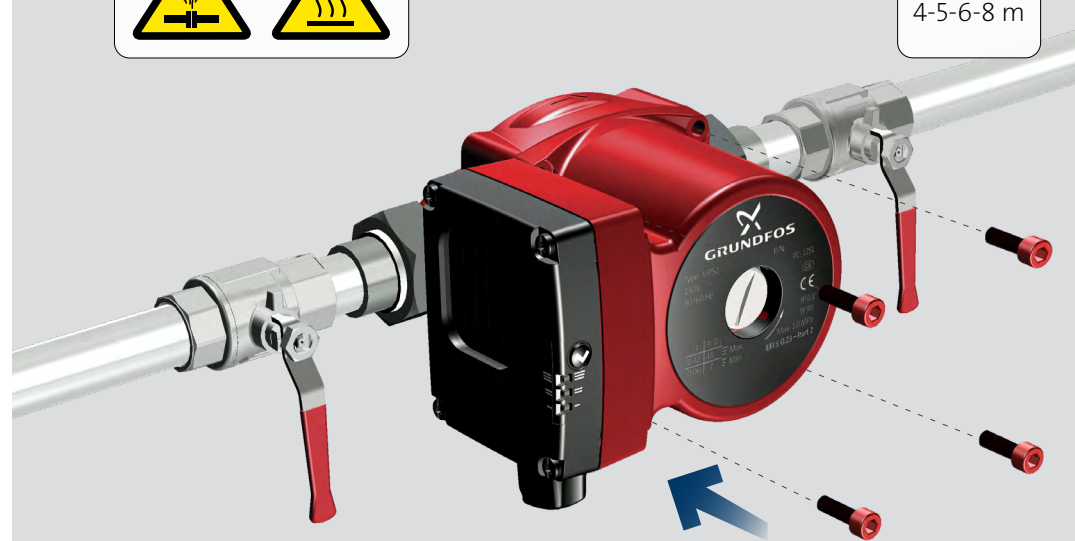



9a



UPS2
4-5-6 m



10a

UPS2
4-5-6 m



11a

UPS2
4-5-6 m





12a

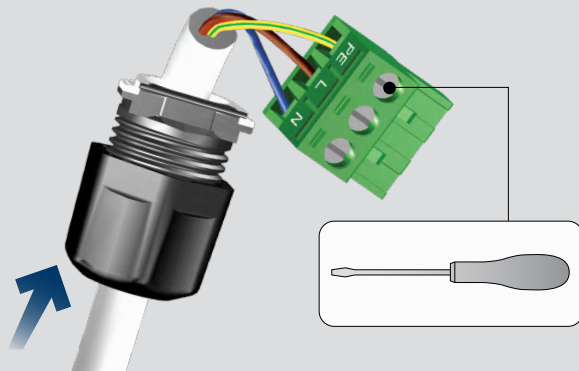
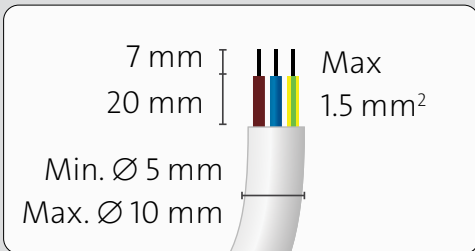

13a



14a





15a

UPS2
4-5-6 m

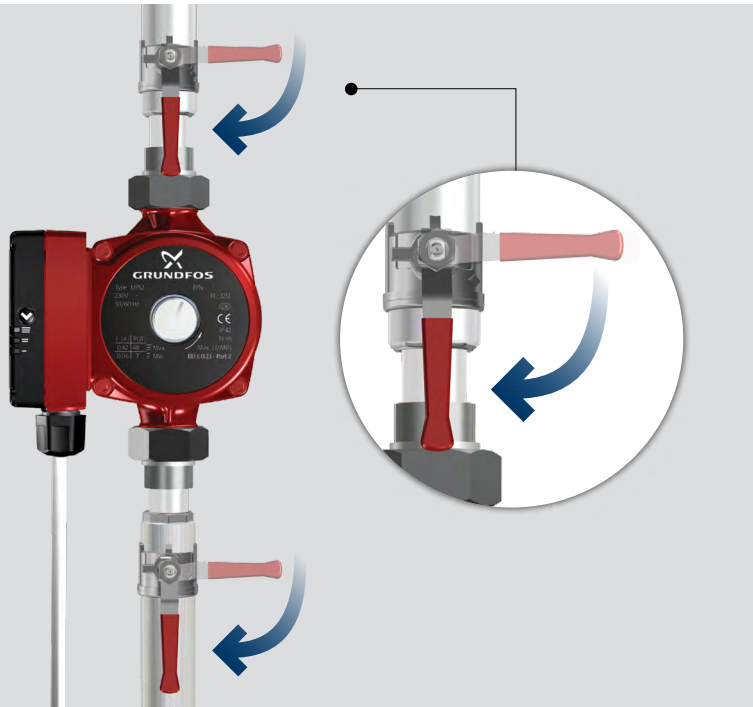

16a

$1 \times 230 \text{ V} \pm 10\%$
 $\sim 50/60 \text{ Hz}$ ⚡



RCD TYPE A

17a

UPS2
4-5-6 m



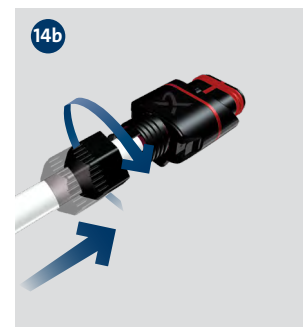
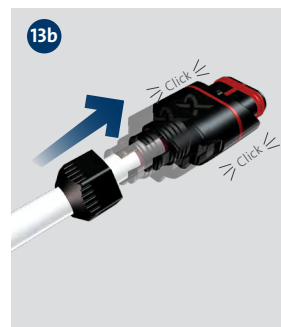
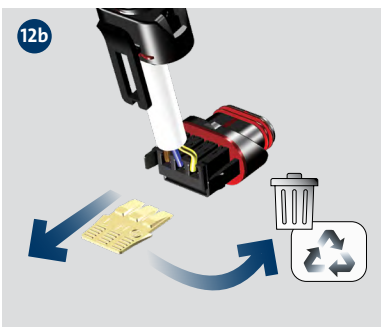
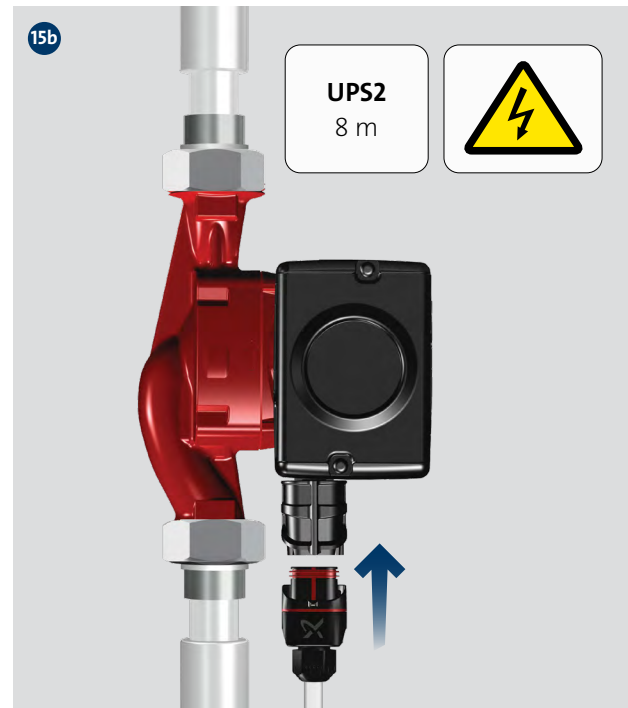
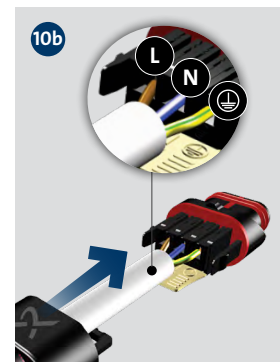
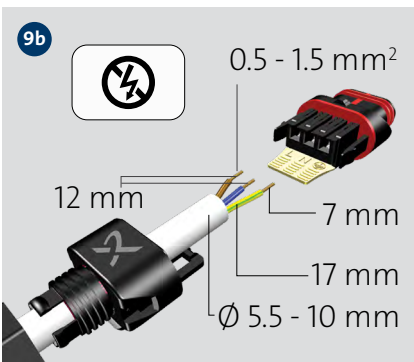



i

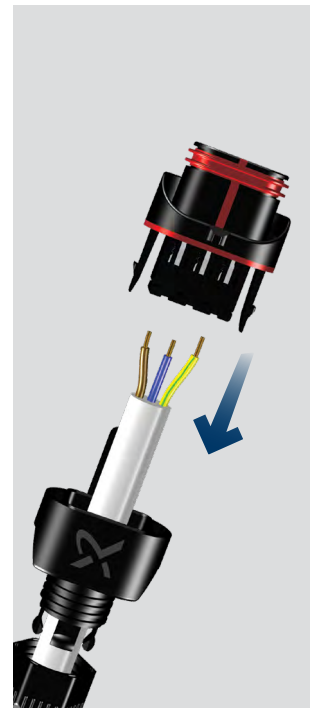
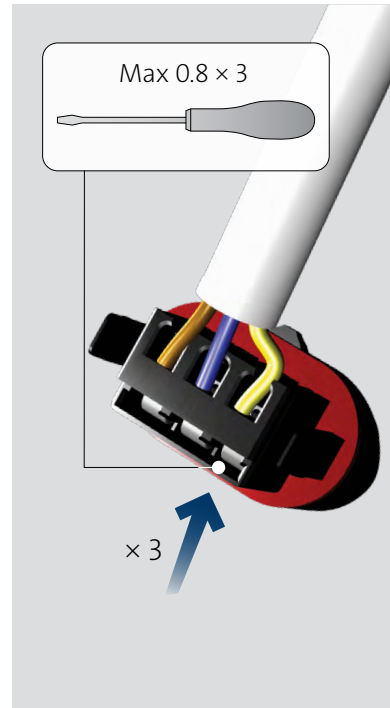
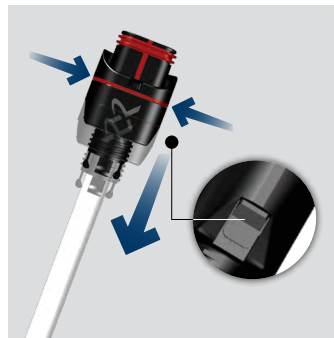
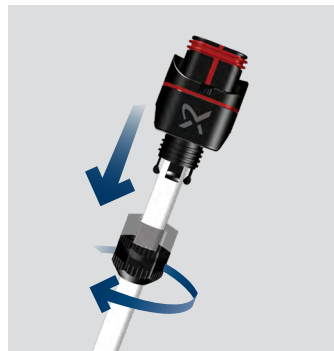
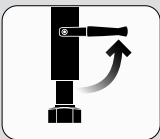



UPS2
4-5-6 m

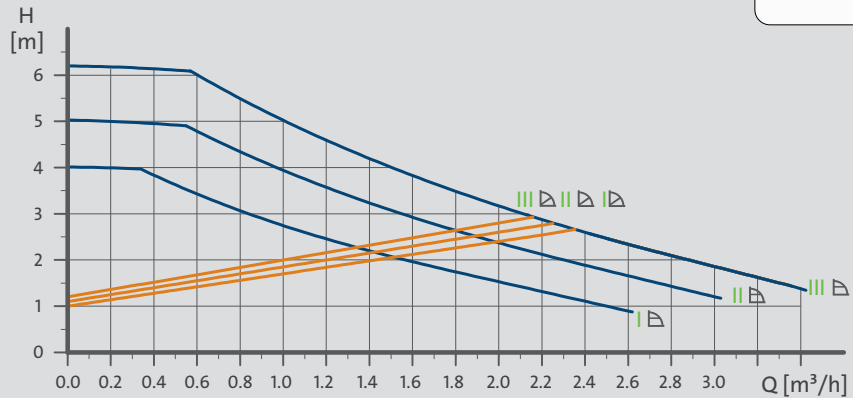

UPS2
8 m

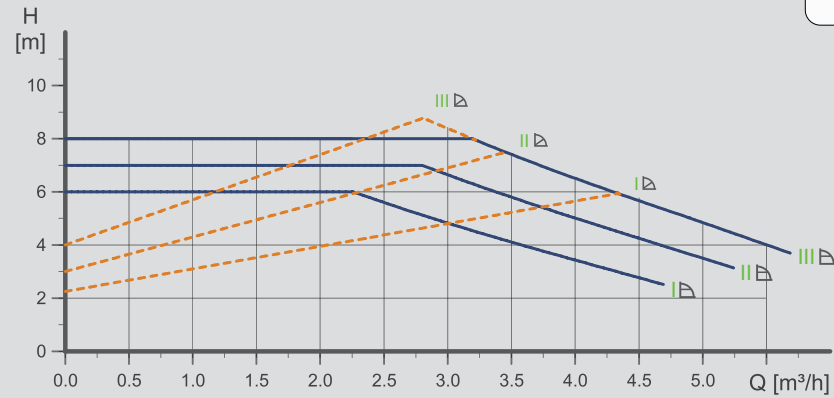



■ = III / II / I
■ = ▢III / ▢II / ▢I

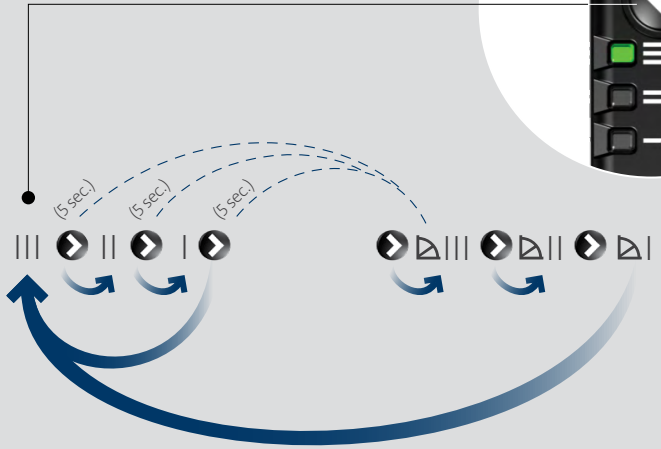

GRUNDFOS
Type UPS2 P/N: PC 1251
230V ~ 50/60 Hz
I (A) P(W) Max. Min.
0.42 48 Max. 0.06 7 Min.
Max. 1.0 MPa
EEI s 0.23 - Part 2

UPS2
4-5-6 m

 ■ = III / II / I

 ■ = III / II / I

 ■ = ▢III / ▢II / ▢I



1 click
PP

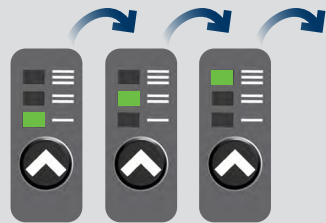

1 click
CP

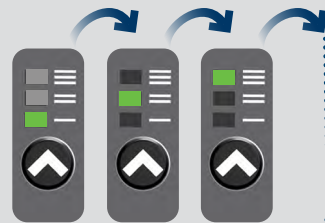

UPS2
8 m

GRUNDFOS
Type: UPS2 P/N: PC: 1438
230V ~ 50/60 Hz
1.10 | 140 Max. Max. 1.0 MPa
0.10 | 11 Min. EEI ≤ 0.23 - Part 2
IP 4
TF 95
CE
E



Conversion table

CURRENT PUMP	SPEED SETTING ON OLD UPS BEING REPLACED	EQUIVALENT SETTING ON NEW UPS2
4 m.	All settings: I-II-III	I
5 m.	I	I
	II	II
	III	II
6 m.	I	I
	II	II
	III	III
8 m.	I	I
	II	II
	III	III



Product No

25*-XX (A)	3/4"	529921
25*-XX (A)	1"	529922
32-XX	1"	509921
32-XX	1 1/4"	509922

*= 15 for UK version

UPS2 8 m



Product No

15-XX	98284561
25-XX	
32-XX	



Product No

15-XX	98610291
25-XX	
32-XX	



BG: Зачеркнатият символ на кофа за отпадъци върху продукта означава, че той трябва да бъде изхвърлен отделно от битовите отпадъци.

Когато маркираният с този символ продукт достигне края на експлоатационния си живот, отнесете го в пункт за събиране на такива отпадъци, посочен от местните организации за третиране на отпадъци. Разделното събиране и рециклиране на подобни продукти ще спомогне за опазването на околната среда и здравето на хората.

GR: Το σύμβολο με τον διαγραμμένο κάδο απορριμμάτων σημαίνει ότι πρέπει να απορριφθεί ξεχωριστά από τα οικιακά απορρίμματα. Όταν ένα προϊόν που φέρει αυτό το σύμβολο φτάσει στο τέλος της διάρκειας ζωής του, παραδώστε το σε ένα σημείο συλλογής το οποίο καθορίζεται από τις τοπικές αρχές διάθεσης απορριμμάτων. Η ξεχωριστή συλλογή και ανακύκλωση τέτοιων προϊόντων θα βοηθήσει στην προστασία του περιβάλλοντος και της ανθρώπινης υγείας.

RO: Simbolul de pebelă întretăiată aflată pe un produs denotă faptul că acesta trebuie deșeurit separat de gunoii menajer. Când un produs cu acest simbol ajunge la sfârșitul duratei de viață, acesta trebuie dus la un punct de colectare desemnat de către autoritățile locale de administrare a deșeurilor. Colectarea și reciclarea separate ale acestor produse vor ajuta la protejarea mediului înconjurător și a sănătății umane.

BG: Декларация за съответствие на ЕО

Ние, фирма Grundfos, заявяваме с пълна отговорност, че продуктът UPS2, за който се отнася настоящата декларация, отговаря на следните директиви на Съвета за уеднаквяване на правните разпоредби на държавите-членки на ЕО.

GR: Δήλωση συμμόρφωσης ΕΕ

Εμείς, η Grundfos, δηλώνουμε με αποκλειστικά δική μας ευθύνη ότι το προϊόν UPS2, στο οποίο αναφέρεται η παρακάτω δήλωση, συμμορφώνεται με τις παρακάτω Οδηγίες του Συμβουλίου περί προσέγγισης των νομοθεσιών των κρατών μελών της ΕΕ.

RO: Declarația de conformitate UE

Noi Grundfos declarăm pe propria răspundere că produsul UPS2, la care se referă această declarație, este în conformitate cu Directivele de Consiliu specificate mai jos privind armonizarea legilor statelor membre UE.

Low Voltage Directive (2014/35/EU)

Standards used:

- EN 60335-1:2012 + AC:2014 + A11:2014 + A13:2017 + A1:2019 + A14:2019 + A2:2019 + A15:2021
- EN 60335-2-51:2003 + A1:2008 + A2:2012

EMC Directive (2014/30/EU)

Standards used:

- EN 55014-1:2006/A1:2009/A2:2011
- EN 55014-2:2015
- EN61000-3-2:2014
- EN61000-3-3:2013

Ecodesign Directive (2009/125/EC)

Commission Regulation (EC) No 641/2009

Commission Regulation (EC) No 622/2012

Standards used:

- EN 16297-1:2012
- EN 16297-2:2012

RoHS Directives: 2011/65/EU and 2015/863/EU

Standard used: EN IEC 63000:2018

Bjerringbro, 17th of February 2022

Jannek Uldal-Christesen
Senior Director
Grundfos Holding A/S
Poul Due Jensens Vej 7
8850 Bjerringbro, Denmark

Person authorised to compile technical file and empowered to sign the EC declaration of conformity.

Bulgaria

Grundfos Bulgaria EOOD
Slatina District, Iztochna
Tangenta street no. 100
BG - 1592 Sofia
Tel. +359 2 49 22 200

Greece

GRUNDFOS Hellas A.E.B.E.
20th km. Athinon-Markopoulou Av.
P.O. Box 71
GR-19002 Peania
Phone: +0030-210-66 83 400

România

GRUNDFOS Pompe România SRL
Bd. Biruintei, nr 103
Pantelimon county Ilfov
Phone: +40 21 200 4100

Installation date: _____

Installer: _____

98676376 06.2022

ECM: 1343067

GRUNDFOS Holding A/S

Poul Due Jensens Vej 7

DK-8850 Bjerringbro

Tel: +45 87 50 14 00

www.grundfos.com

GRUNDFOS 

Trademarks displayed in this material, including but not limited to Grundfos, the Grundfos logo and "be think innovate" are registered trademarks owned by The Grundfos Group. All rights reserved.

© 2022 Grundfos Holding A/S, all rights reserved.